

B 128

IML
MACHINERY

Macchina per montaggio alette su cartelle a tre lembi

Macchina elettropneumatica a due teste con alimentazione automatica delle alette laterali, inserite in un apposito caricatore verticale a caricamento continuo. A richiesta dal cliente la macchina può essere occhiellatrice o rivettatrice. L'operatore applica un'aletta, poi ruota la cartella e applica la seconda.

Machine for fixing flaps on 3-flaps folders

Electro-pneumatic machine with two heads and automatic feeding of lateral flaps, loaded in a special vertical hopper with continuous feeding. The machine can be supplied for eyeleting or riveting on request of the customer. The operator applies one flap then rotates the folder and applies the second flap.

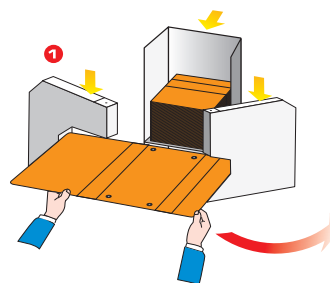
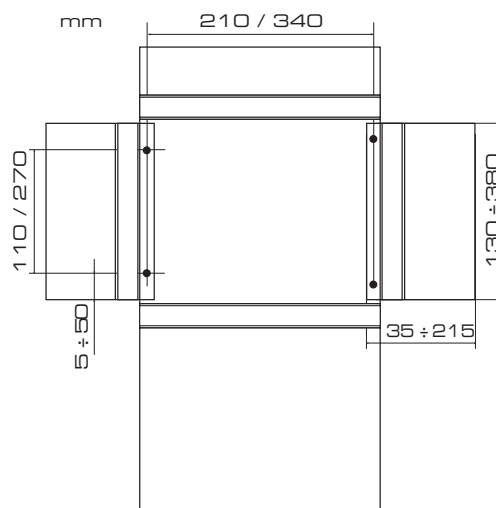
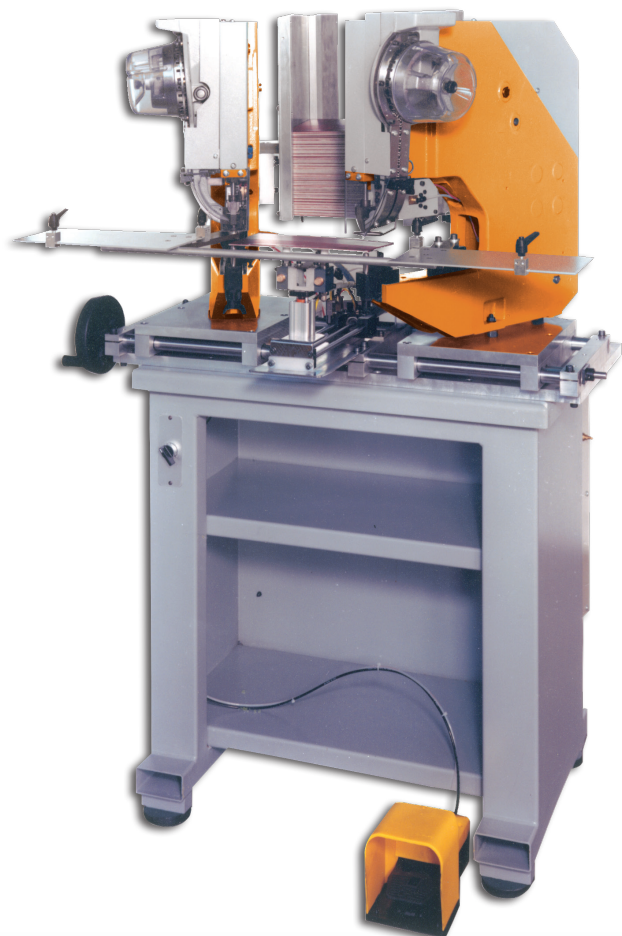
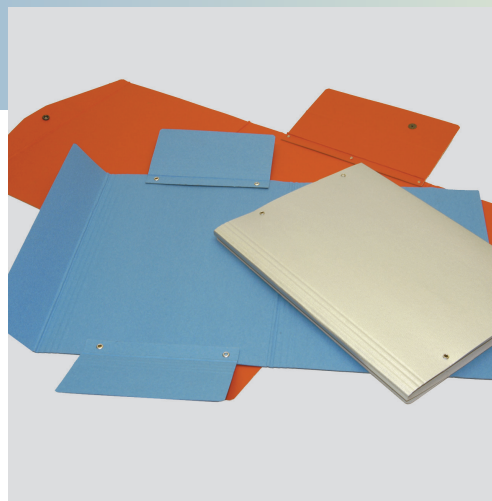

Dynamic process

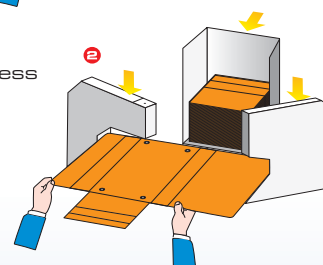

- Materiale utilizzato: Cartone rivestito, Fibrone, Polipropilene.
- Occhielli/Rivetti: A richiesta.
- Spessore cartone: da 0,5 mm a 2,5 mm
- Produzione: 12 pezzi/minuto*
- Voltaggio: 220 Volt monofase
- Consumo pneumatico: 8 NL/ciclo (6 bar)
- Dimensioni: L= 1200 mm; P= 800 mm; H= 1440 mm.
- Peso: Kg. 200

- Used Material: Coated board, Fiber board, PP.
- Eyelets/Rivets: On request.
- Cardboard thickness: 0,5 mm to 2,5 mm
- Capacity: up to 12 pieces/minute*
- Voltage: 220 Volt single-phase
- Compressed air: 8 NL/cycle (6 bar)
- Overall dimensions: L= 1200 mm; P= 800 mm; H= 1440 mm.
- Weight: Kg. 200

* Production capacity of every machine depends on sizes, type of materials, glues and operator skill
IML reserves the right to change technical specifications without notice.

VARIOUS PRODUCTS